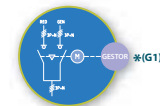
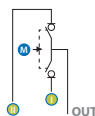

CTR2 | CTRC

Metal enclosed transfer switch IP54-IP66

3P - 3P+N

Size 4
A 1600|1800|2000

CTR2 (IP65)
manualCTRC (IP66)
motorizedCTRC (IP54)
motorized with control module

Accessories



» **External handle** included in CTR2
IP65
CODE D5LLA31



» **Auxiliary contacts**
1NO+1NC CODE DS-AU11
2NO+2NC CODE DS-AU12
Ie = 16 A (resistive loads)
4 A (inductive loads) at 250 Vac.



» **Terminal shrouds** for CTR2
CODE DS-CU41
(1 kit for input or output only frontal side)



» **Bridging links** for CTR2
CODE D5LPC42 (4 units)



» **Safety key lock device** for CTR2
Simple CODE D5LCB41
Double CODE D5LCF41

For external handle, lock the handle by means of a key in position "OFF" (under request, in "ON"), the key can only be removed with the handle locked



» **Control module***(G1)

- » LCD graphic screen
- » 3 analog inputs for resistive sensors:
 - Oil pressure
 - Coolant temperature
 - Fuel level
- » 5 + 3 digital inputs:
 - 4 programmable, negative
 - 3 programmable, negative, alternative to resistive sensors
 - 1 emergency stop button, positive
- » 6 digital outputs:
 - 6 positive static outputs protected
- » Operation with universal battery 12-24 Vdc

*G1 The control module and its features are subject to change, please consult

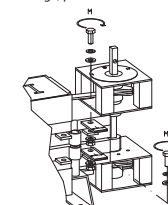

H max (Cu)	L max (Cu)	M
mm	mm	Nxm
2x10	80	M14 55

Dimensions (mm)

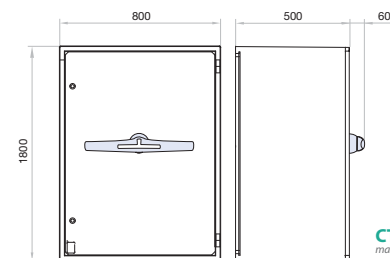
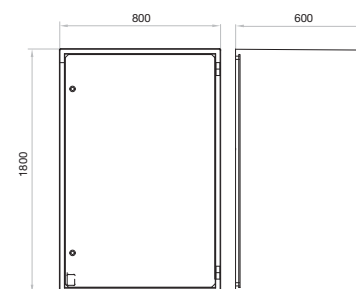
CTR2
manualCTRC
motorized with control module

Technical information

According to IEC 60947-3
IEC 61439-2

			1600	1800	2000
Rated thermal current	Ith in ambient at 40° C	A	1600	1800	2000
Rated insulation voltage	Ui	V	1000	1000	1000
Rated impulse withstand voltage	Uimp	kV	12	12	12
AC Rated operational current ^(*)	Ie Ue 400V AC21A	A	1600	1800	2000
(Rated operational frequency 50/60 Hz)	Ue 400V AC22A	A	1600	1800	2000

^(*) Other voltages and / or utilization categories. Please consult

^(*) Without limiting protective device (short-circuit maintained 50 ms. - 100 ms.)

^(*) Please consult us for CTRC motorized operations

			1600	1800	2000
Rated breaking capacity	400V AC22	A	4800	5400	6000
Rated making capacity	400V AC22	A	4800	5400	6000
Short - circuit behaviour					
Short - circuit making capacity ^(*)	Icm	kA (peak)	75	75	75
Short - time withstand current (1 sec.)	Icw	kA rms	50	50	50
Number of mechanical operations (according to the standards, for other values please consult CTR2 ^(*))	Cycles		3000	3000	3000
Maximum weight (3/4 poles)	Kg		Consultar		



Also available 4P changeover switches under request, please consult

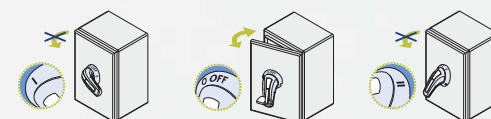

Standard supply CTR2